

 **Eagle Rock**  
**414 Avenue**  
West Orange, NJ



## MEDICAL/PROFESSIONAL FOR LEASE

- 54,799 SF building
- 650 SF - 24,384 SF (*see pages 4-5 for the various suite sizes & uses available*)
- Medical/Professional use
- Capital improvements underway include new LED lighting, carpeting, ceiling tiles, wallcoverings, window frosting, restroom upgrades, and elevator refurbishment. Scheduled completion date: Aug 1, 2024

### Excellent Location!

- Located just off Route 280, perched on a cliff next to the very busy Chit Chat Diner
- Excellent views of the New York City skyline
- Next to the New York City Observatory and Eagle Rock Reservation

**Darren M. Lizzack, MSRE**  
Vice President





201 488 5800 x104  
dlizzack@naihanson.com



**Randy Horning, MSRE**  
Vice President

201 488 5800 x123  
rhorning@naihanson.com

**NAI James E. Hanson**  
COMMERCIAL REAL ESTATE SERVICES, WORLDWIDE

FOLLOW US!      | Offices: Teterboro | Parsippany | Allentown • [naihanson.com](http://naihanson.com) | [naisummit.com](http://naisummit.com) • Member of NAI Global with 325+ Offices Worldwide

#### SERVICES OFFERED

Brokerage • Property Management • Corporate Services • Financing • Tenant Representation • Cold Storage • Investment Services

The information contained herein has been obtained from sources considered to be reliable, but no guarantee of its accuracy is made by NAI James E. Hanson



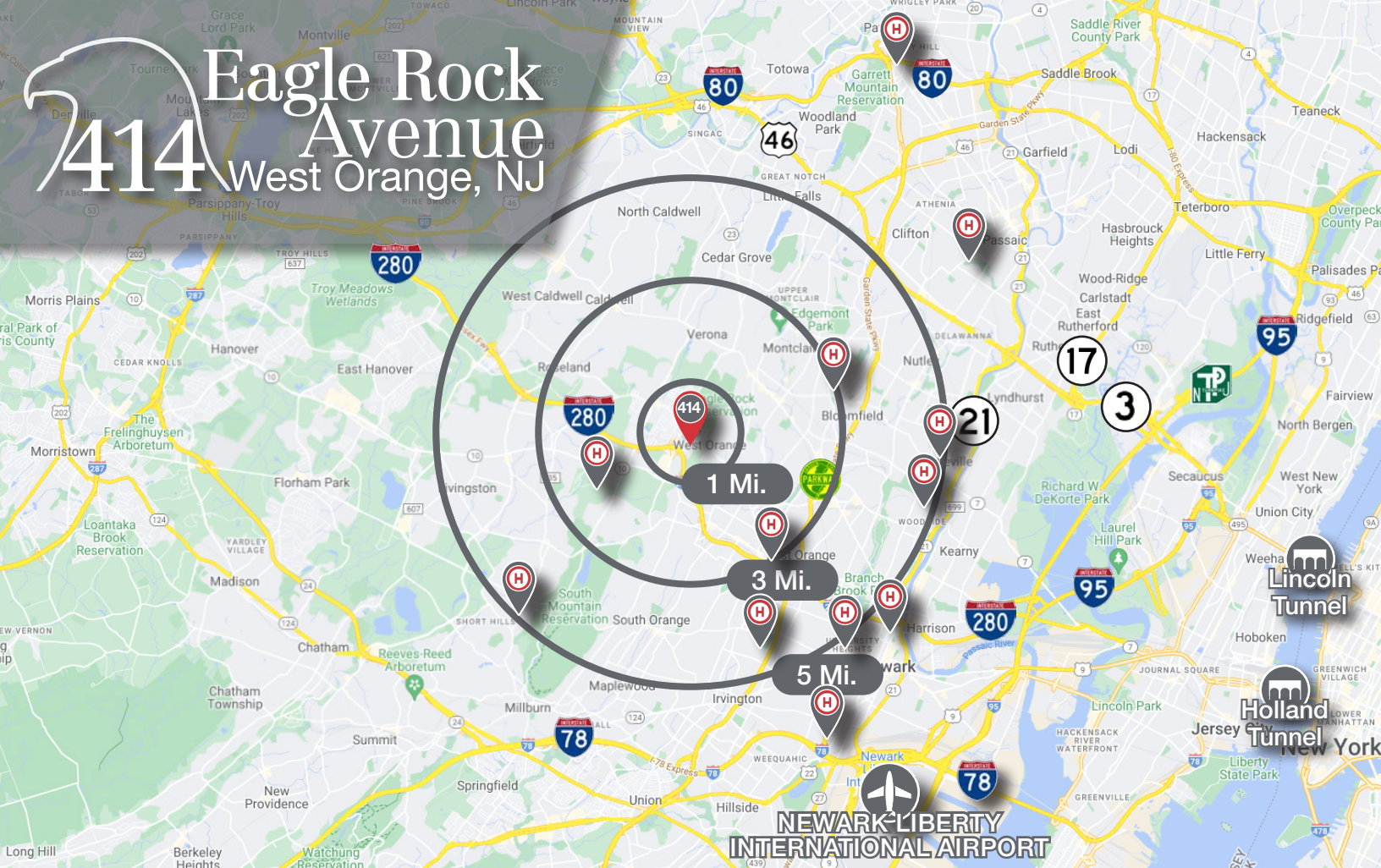

## Medical Tenants AT 414 Eagle Rock Avenue

- Dentist
- Physical Therapy
- Optometrist
- Psychologist

## Surrounding Hospitals:

- Kessler Institute (2.5 mi.)
- Mountainside Medical Center (3.5 mi.)
- Orange Memorial Hospital (3.8 mi.)
- Care Well Health (4.8 mi.)
- Silver Lake Hospital (4.9 mi.)
- Clara Maass Medical Center (5 mi.)
- Cooperman Barnabas Med. Ctr. (5 mi.)
- Rutgers Health/University Hospital (6.5 mi.)
- Atlantic Health General Hospital (8 mi.)
- St. Joseph's Univ. Medical Center (9 mi.)
- St. Mary's General Hospital (10 mi.)
- RWJ Barnabas Med. Ctr. (12 mi.)



# Eagle Rock 414 Avenue West Orange, NJ

## Location Map



### First Floor VACANCIES

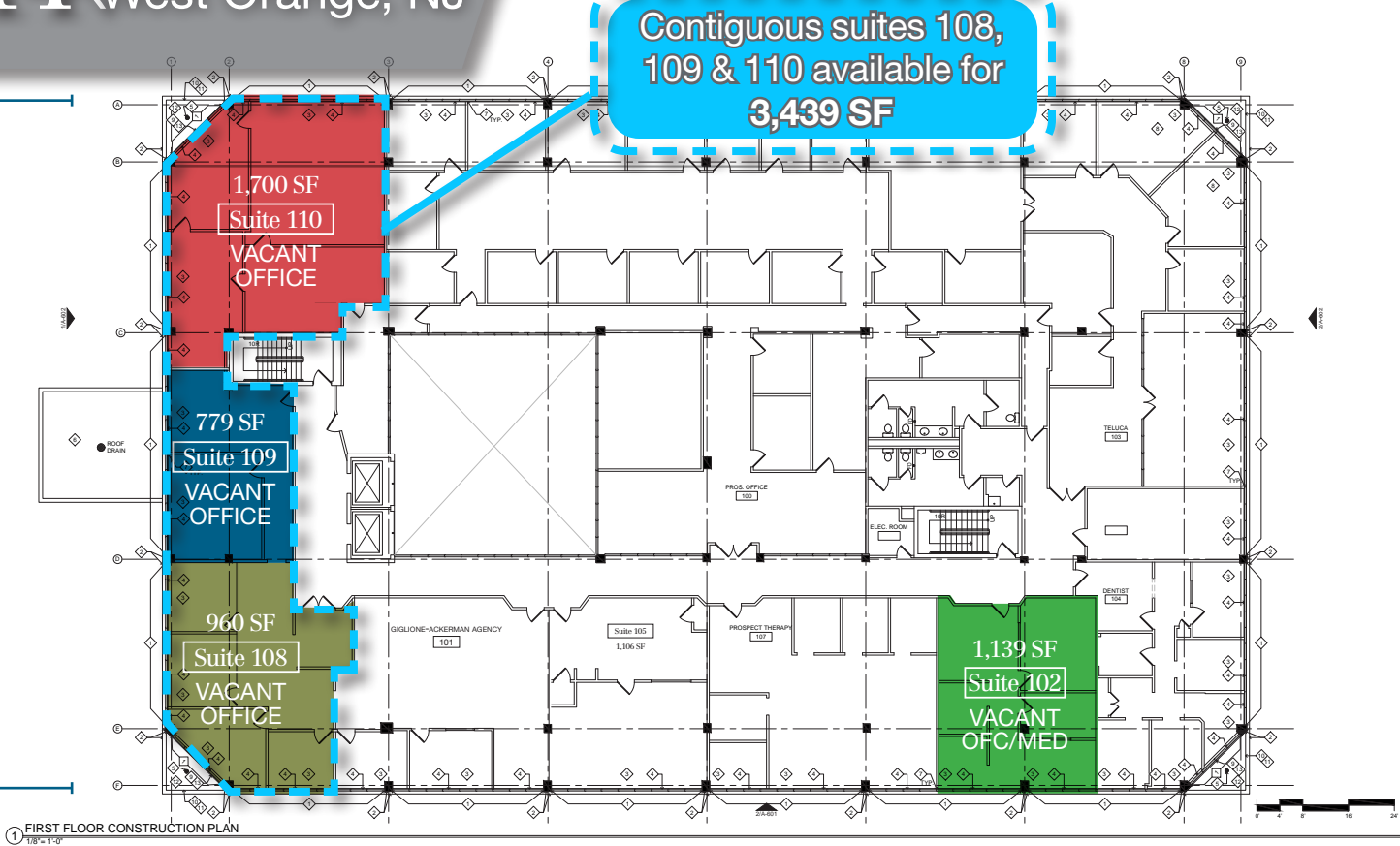

### Second Floor VACANCIES

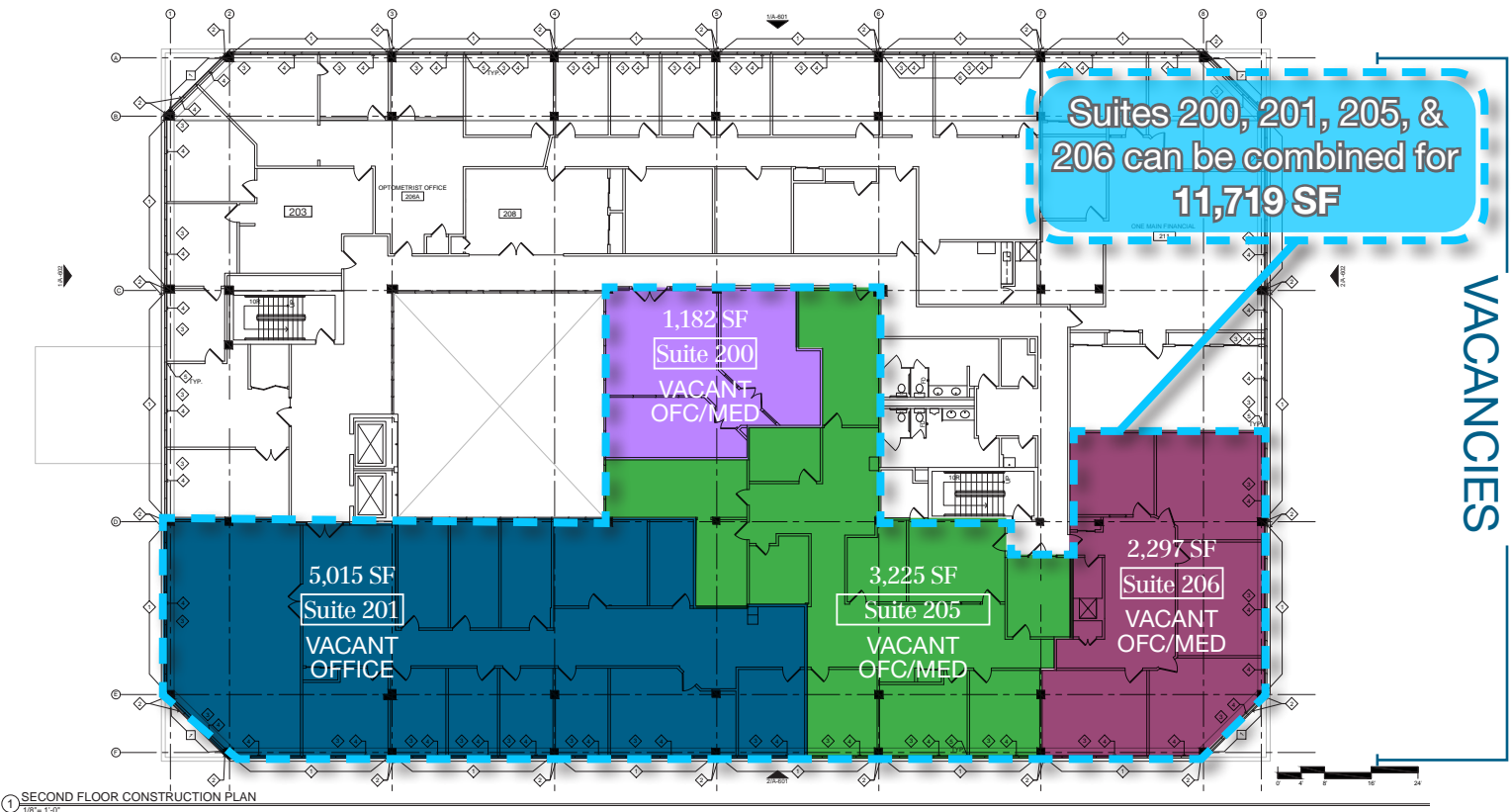



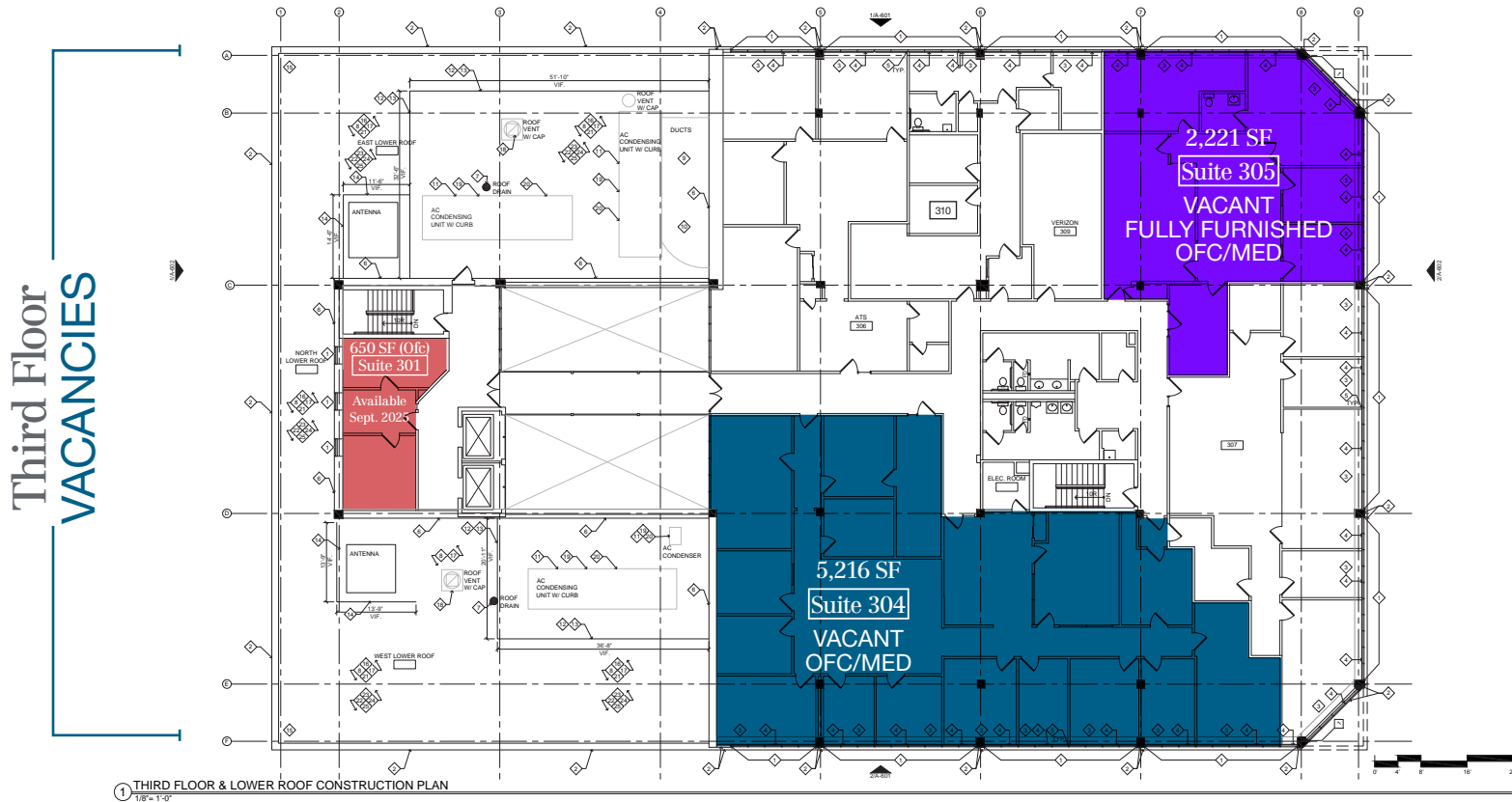

## All Vacancies

### First Floor

- Suite 102: 1,139 SF
- Suite 108\*: 960 SF  
- Beautifully renovated  
- Fully furnished possible
- Suite 109\*\*: 779 SF
- Suite 110\*: 1,700 SF

\*Suites 108, 109 & 110 can be combined for 3,439 SF

\*\*Suite 109 is only available as part of a contiguous lease with Suite 108, Suite 110, or both.

### Second Floor

- Suite 200\*: 1,182 SF
- Suite 201\*: 5,015 SF
- Suite 205\*: 3,225 SF
- Suite 206\*: 2,297 SF  
- 1 restroom with a sink and toilet

\*Suites 200, 201, 205 & 206 can be combined for 11,719 SF

### Third Floor

- Suite 301: 650 SF  
- Coming September 2025
- Suite 304: 5,216 SF  
- Fully furnished  
- 1 sink and pantry area
- Suite 305: 2,221 SF  
- Fully furnished





# Eagle Rock 414 Avenue West Orange, NJ

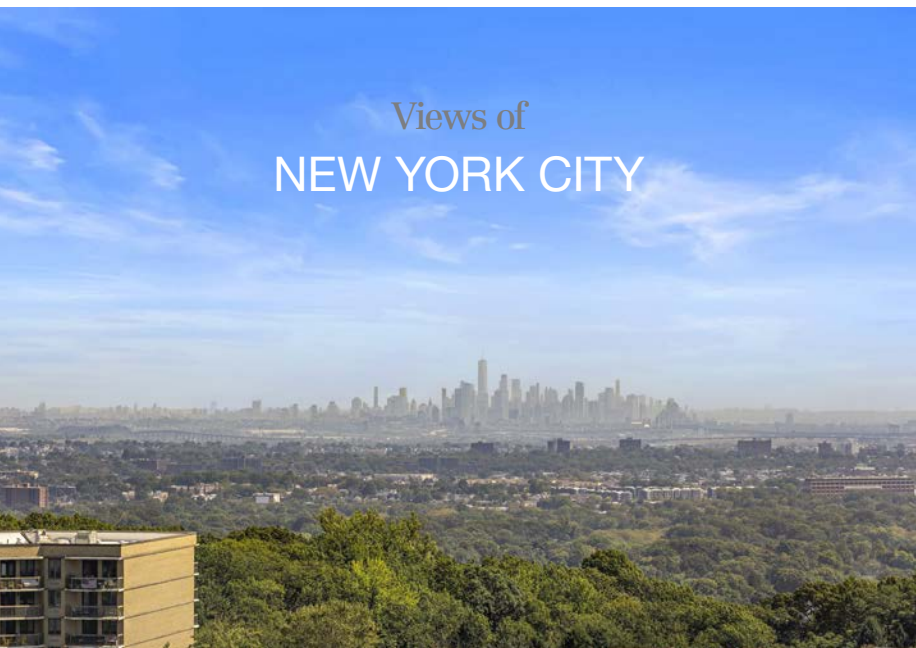

Views of  
NEW YORK CITY



NEW YORK CITY



# Eagle Rock 414 Avenue West Orange, NJ





# Eagle Rock 414 Avenue West Orange, NJ

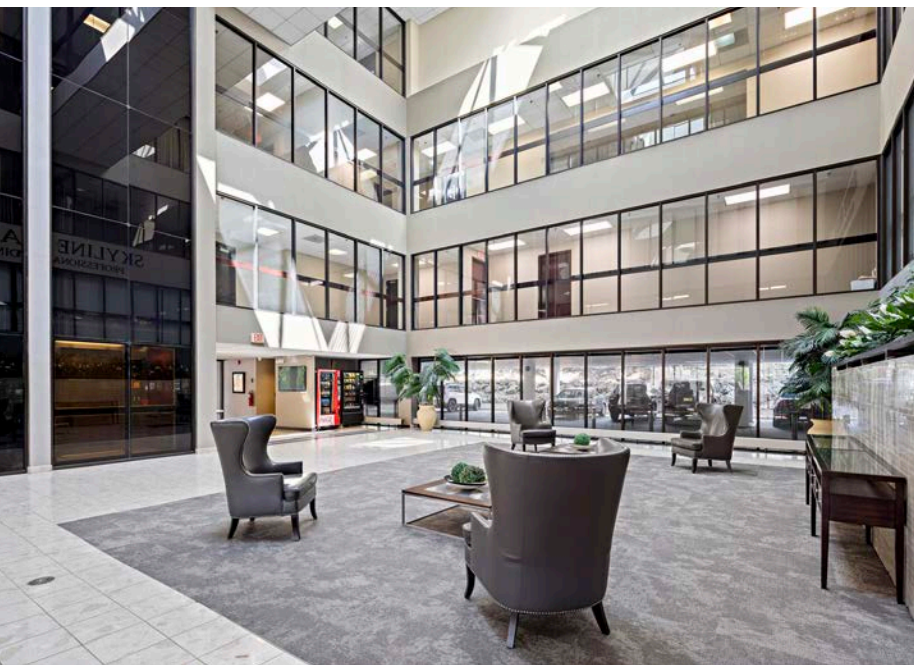





# Eagle Rock 414 Avenue West Orange, NJ



Medical/Professional For Lease

**NAI** James E. Hanson  
COMMERCIAL REAL ESTATE SERVICES, WORLDWIDE

The information contained herein has been obtained from sources considered to be reliable, but no guarantee of its accuracy is made by NAI James E. Hanson